

Swan Lake North & South

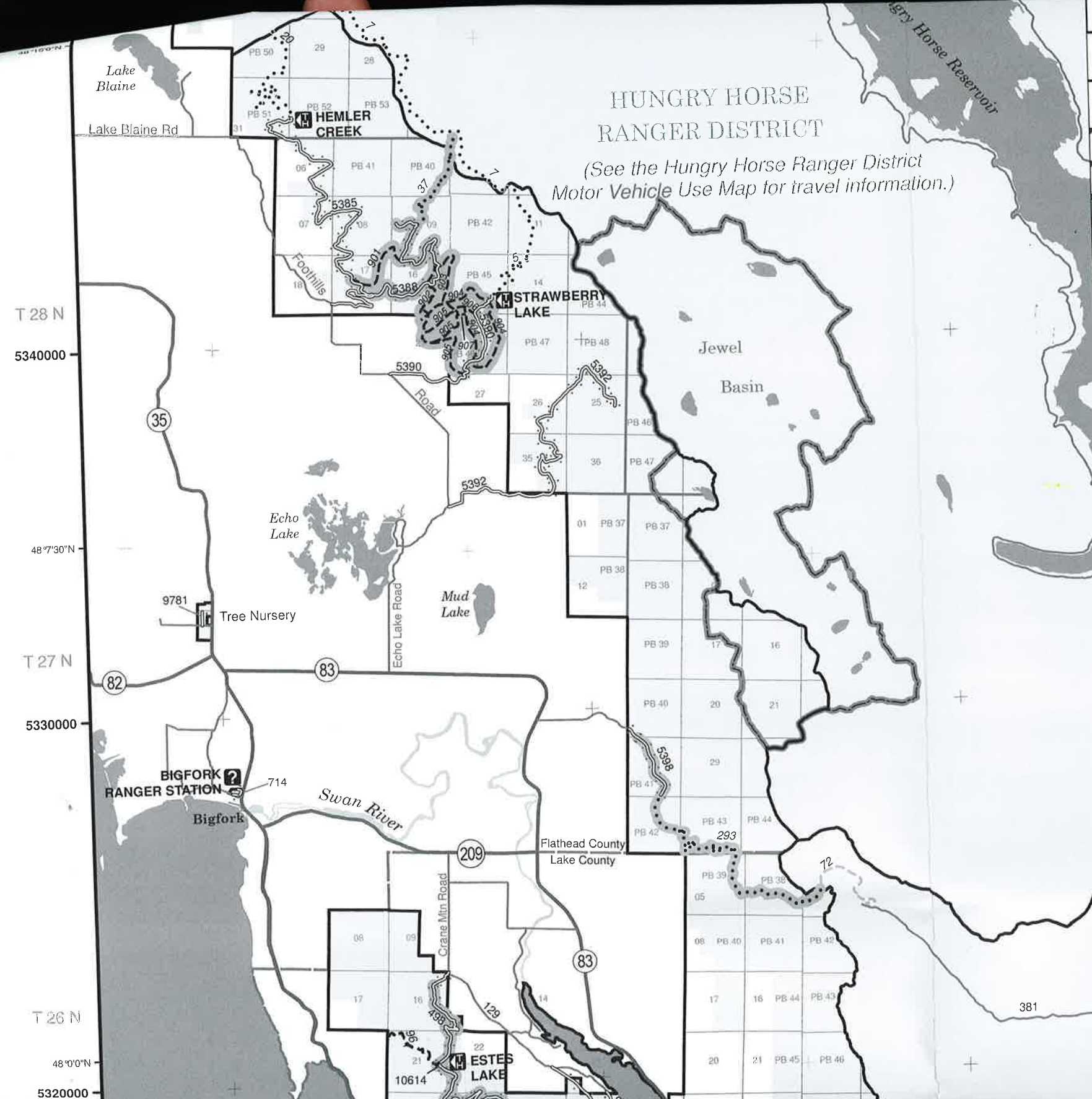

HUNGRY HORSE RANGER DISTRICT  
 (See the Hungry Horse Ranger District Motor Vehicle Use Map for travel information.)

Route Number	Dates Allowed	Beginning Mile Post	Ending Mile Post
<b>Roads Open to Highway legal vehicles only, with Seasonal Designation</b>			
10182	06/15-03/31	5.426	5.715
10229	04/01-11/30	0.400	4.480
10381	07/01-03/31	0.000	5.097
10381	06/16-03/31	5.097	8.368
10614	04/01-11/30	0.000	0.080
498	04/01-11/30	0.345	16.162
5388	07/01-03/31	0.000	4.300
5398	07/01-11/30	1.918	3.100
9501	12/01-10/14	0.000	0.560
9507	12/01-10/14	0.760	2.275
9509	12/01-10/14	0.000	1.200
9514	12/01-10/14	0.000	5.920
9591	12/01-10/14	6.486	9.300
9714	04/01-11/30	0.000	1.240
9714	04/01-11/30	1.640	1.690
9714	04/01-11/30	2.290	2.340
9714	04/01-11/30	2.490	2.590
9714	04/01-11/30	2.740	9.490
<b>Trails open to motorcycles, with Seasonal Designation</b>			
Peterson Cr. 293	07/01-11/30	0.000	5.930
Peterson Ridge 37	07/01-03/31	0.000	2.600
<b>Trails open to vehicles 50" or less in width, with Seasonal Designation</b>			
901	01/01-03/31, 07/01-08/31, 12/01-12/31	0.000	1.230
902	01/01-03/31, 07/01-08/31, 12/01-12/31	0.000	1.520
903	01/01-03/31, 07/01-08/31, 12/01-12/31	0.000	1.260
904	01/01-03/31, 07/01-08/31, 12/01-12/31	0.000	3.990
905	01/01-03/31, 07/01-08/31, 12/01-12/31	0.000	3.280
906	01/01-03/31, 07/01-08/31, 12/01-12/31	0.000	0.550
907	01/01-03/31, 07/01-	0.000	0.170